

# **PARK MASTER PLAN FOR THE TOWN OF BERGEN ROBINS BROOK PARK AND DREW'S NATURE CENTER DRAFT COPY**



**CHATFIELD ENGINEERS, P.C.**  
2800 DEWEY AVENUE  
ROCHESTER, NY 14616  
(585) 227-6040  
[www.chatfieldengineers.com](http://www.chatfieldengineers.com)

**DECEMBER 20, 2017**



**DRAFT COPY**  
**TOWN OF BERGEN**  
**ROBINS BROOK PARK**  
**AND**  
**DREW'S NATURE CENTER**  
**MASTER PLAN**  
**GENESEE COUNTY, NEW YORK**  
**DECEMBER 20, 2017**

**I. INTRODUCTION**

**A. Purpose and Scope:**

The purpose of this Park Master Plan is to provide the Town Board with the guidance and direction for short and long-term improvements to the Town of Bergen facilities at Robins Brook Park and Drew's Nature Center.

**B. Background**

The Town of Bergen owns the 28-acre parcel of land where the Robins Brook Park is located. Robins Brook Park was originally constructed in the late 1980's.

The northeastern portion of the property was previously used for a town landfill that was closed in October 1984. According to the Closure/Post Closure Engineering Report prepared by MRB Group, the facility continued to operate as a Construction and Demolition Debris Pit until final closure in the Fall of 1987.

Additional improvements to Robins Brook Park took place around 2007 and consisted of construction of additional soccer field and baseball/softball fields. Other improvements have been made by the Town Highway Department consisting of parking lot improvements and access improvements.

The Drew Nature Center property is owned by the Town of Bergen. The two (2) parcels consists of approximately 50 acres with ponds and trails with limited improvements. Access to the Drew's Nature Center is via an abandoned railroad bed which runs between West Sweden Road and NYS Route 19.

**C. Parks and Recreation Goals**

The Town and Village of Bergen completed the Comprehensive Plan in July 2016, which included a section on the parks and recreation needs and desires.

The goals established in the Comprehensive Plan relating to parks and recreational needs included the following:

- *Provide and maintain sufficient parks and recreational facilities that meet the needs of all age groups for active and passive recreation.*
- *Design recreational sites that promote the health and fitness of all residents.*
- *Provide a system of interconnected parks, bikeways and trails.*



## **II. PROJECT PLANNING AREA**

### **A. Project Location**

The Town of Bergen is located in the northeastern portion of Genesee County, as shown in **Figure 1**.

Robins Brook Park is located on NYS Route 262 approximately 0.65 miles west of Jericho Road, and approximately 0.50 miles east of the Byron Bergen Central School District property.

Drew's Nature Center is located on West Sweden Road approximately 0.15 miles south of Swamp Road and immediately adjacent to the abandoned railroad bed.

Refer to **Figure 2** for a Map of the Robins Brook Park and Drew's Nature Center Locations.

### **B. Environmental Resources Present**

The area adjacent to Robins Brook Park is generally farmland and rural residential areas. Robins Brook traverses through the middle of the park property. Railroad tracks are located along the south boundary of the park property and NYS Route 262 (Town Line Road) is located along the northern portion of the property.

The area adjacent to Drew's Nature Center is generally swamp land. The southern boundary is adjacent to the abandoned railroad tracks.

As part of the project planning process, a complete environmental review will take place including the State Environmental Quality Review (SEQR) Act.

Based upon our review of the SEQR Regulations, we anticipate that improvements to each park will be considered a Type 1 Action according to SEQR, Section 617.14, paragraph (b)(10), since it is likely that more than 2.5 acres of land will be altered as a result of the Project.

The National Environmental Policy Act (NEPA) will be completed if Federal funds are provided.

### **C. Population Trends**

According to the U.S. Census data, the Town of Bergen population is summarized as follows:

<u>Year</u>	<u>Population</u>
2000	3,182
2010	3,120
2013	3,102

Based upon the available data, it appears that the population within the Town of Bergen is decreasing slightly.



## **D. Community Engagement**

As part of the Comprehensive Plan completed in 2016, a community survey was completed. One of the topics covered was the importance of parks and recreational facilities within the Town. The results of the community survey were taken into consideration in preparation of this Report. The Town of Bergen formed a Parks Committee and developed a Bergen Town Park Master Plan which was incorporated into the Comprehensive Plan.

The Town of Bergen has involved the Genesee BOCES Program to complete some trail work, erosion control measures, and constructing an informational kiosk at Drew's Nature Center. In addition, the students may also construct some benches and address options for Phragmites control.

It is anticipated that the public will be informed of the proposed improvements through a series of newsletters, the Town's website, Public Information Meetings and will seek input and feedback from the residents.

## **E. Demand for Recreational Facilities**

Based upon discussions with Town Officials and review of the Comprehensive Plan, there is a demand for improvements to each facility; specifically, additional sports fields and pavilion(s) at Robins Brook Park and parking improvements and a pavilion at Drew's Nature Center.

Based upon visual observations made throughout the summer of 2017, Robins Brook Park is very busy with sporting activities.

Parking at Robins Brook Park and Drew's Nature Center is at a premium and an area that needs to be addressed for the long-term enjoyment and access for the users of the facilities.

## **III. EXISTING FACILITIES**

### **A. General**

Robins Brook Park existing facilities include the following amenities:

- 3 soccer fields.
- 3 ball fields plus 2 T-Ball fields.
- Parking lots north and south of Robins Brook.
- Temporary toilet facilities.

Drew's Nature Center is a passive park that includes the following amenities:

- Ponds.
- Hiking trails.
- Informational Board.
- Parking area.

Photographs of the existing facilities are included in **Appendix A**.





## **B. History**

Robins Brook Park was originally owned by the Village of Bergen and the northerly portion of the property served as the Bergen Landfill and later as the Bergen Transfer Station. The Town, by Agreement, took over operation of the Refuge Center and the operation and maintenance of the property, used as Robins Brook Park.

Around 2007, improvements were made to the Robins Brook Park including clearing of land and construction of additional fields for use, south of Robins Brook. Around the same time, improvements were made to the driveway access to the rear of the property and parking lot improvements.

It has been reported that the Drews Nature Center property was donated to the Town of Bergen by the Drew family. The date of the transfer was not readily available at the time of preparation of this report.

## **C. Condition of Existing Facilities**

The ball field and soccer fields at Robins Brook Park are in excellent condition and well maintained by the Town of Bergen Highway Department.

The parking area at the Drews Nature Center is well maintained but very limited in size. In addition, due to the layout of the parking area, there is limited available parking for visitors of the Nature Center. The trails around the ponds are somewhat overgrown with vegetation and in need of attention.

## **IV. NEED AND DEMAND FOR RECREATIONAL OPPORTUNITIES**

Both facilities have experienced continued and increased use over the years. Recreational opportunities for the Town residents is an important amenity and efforts should be made to make the necessary improvements.

## **V. ALTERNATIVES CONSIDERED**

The alternatives to consider include the following:

- A. Do nothing:** The Town could continue to operate each facility "as is" without making any improvements. This alternative would not address the increased demand for the facilities and will limit the potential use of the facilities.
- B. Complete improvements all at once:** The Town could complete all of the recommended improvements at one time which would allow for a quicker time period for use of the facility.

The Town could apply for grants and low interest loans to finance the improvements. To accelerate the construction, work could be publicly bid and completed by contractors specializing in park improvements.

- C. Complete improvements over an extended period of time:** The Town could budget improvements over an extended period of time and complete the improvements with their own town forces.



relocating "offsite" or possibly moving east of the existing site in the gravel parking lot area.

The gravel paring area east of the existing transfer station could be used for other functions such as pickle ball courts, tennis courts, basketball courts, additional parking, etc.

- Re-arrange the roadway network for a better flow of traffic.
- Provide improved parking in several areas throughout the park.
- New fencing along the front of the property parallel to NYS Route 262.
- Install trees and shrubs throughout the property.
- Install additional fields (soccer, T-Ball and youth baseball/softball) in the northern portion of the property, north of Robins Brook Creek. Those fields could be maintained as "multi-use fields" for flexibility in programming.
- Construct an "open air" pavilion north of Robins Brook Creek.
- Construction a small "kiddie" playground north of Robins Brook Creek.
- Provide additional parking south of Robins Brook Creek.
- Construct a hiking trail around the perimeter of the park with park benches, signage and fitness stations throughout the trail.
- Construct an "open air" pavilion south of Robins Brook Creek. An attached enclosed portion would be provided for concessions and storage of equipment.
- Provide additional portable bleachers.
- Provide picnic tables (including handicap accessible tables).
- Provide cooking grills.
- Provide a new park sign for the facility.
- Construction of restroom facilities



The proposed improvements for Drew's Nature Center are provided in **Figure 4**.

**The Drew's Nature Center recommended improvements include:**

- Provide improved parking off West Sweden Road.
- Locate the proposed informational kiosk off the parking lot.
- Provide trail improvements around Drew's Nature Center.
- Install interpretative signage throughout the trail system.
- Provide park benches throughout the trail system.
- Install a gazebo with easy access directly off the abandoned railroad bed for easy access for those with physical limitations.
- Install viewing platforms.

Included in **Appendix B** are some examples of various components (manufacturers cut sheets and photographs) to be considered for the recommended improvements.

**B. Project Schedule**

The anticipated Project Schedule will be determined once the financing has been reviewed and accepted by the Town of Bergen.

The project could be completed all at once or on a phased approach, based upon available funding.

The general steps to be taken include:

- Town apply for and receive grant funding.
- Town to evaluate their local share cost.
- Town Board accept Preliminary Plan or request modifications.
- Completion of the environmental review process.
- Design Phase of Improvements.
- Submission to agencies for approvals & permits.
- Bidding Phase.
- Construction Phase and Final Restoration.
- Completion and Project Closeout.



### C. Permits, Approvals and Easement Requirements

The Project will require permits and approvals from the following agencies:

- NYS Department of Transportation Highway Work Permit (if improvements are made to the existing curb cut).
- Funding agency approval.
- NYS DEC Storm Water Pollution Prevention Plan (SWPPP).

### D. Preliminary Cost Estimate (Engineers Opinion of Probable Costs)

The summary of estimated for the proposed project are as follows:

a.	Construction	\$ 562,000
b.	Contingency	\$ 56,200
c.	Engineering Services	\$ 67,440
d.	Legal and Administrative	<u>\$ 32,860</u>
	<b>Total Project Costs</b>	<b>\$ 726,000</b>
	Less SAM Grant	<u>(\$ 125,000)</u>
	<b>Net Local Share Amount</b>	<b>\$ 601,000</b>

Annual debt service payment (5% for 20 years) \$ 48,225.79

Taxable Town Assessed Valuation (2017) \$ 159,276,030

Estimated Tax Rate for the Project/ \$1,000 AV \$ 0.3028

Estimated Single Family Home (SFH) Assessed Valuation \$ 100,000

**Estimated Annual debt service for Typical SFH \$ 30.28**

Refer to **Table 1** at the end of this report for a detailed Cost Estimate of the Proposed Project.

### E. Annual Operating Budget

#### 1. Income.

The Town of Bergen should charge a fee for use of the facilities at Robins Brook Park to help offset some of the expenses associated with the improvements being considered. The Town Board should review the project budget and make a determination of the necessary charges for the facilities.

#### 2. Annual Operation and Maintenance (O & M) Cost

The Town of Bergen will be responsible for the Operation and Maintenance (O&M) of the proposed park improvements. The cost for O & M is included in the existing Town budget and is not anticipated to increase as a result of the proposed improvements.





### **3. Debt repayments**

The debt service on the initial project costs will be based on Assessed Valuation Method and will be included in the Town's annual budget process.

The Town of Bergen intends to apply for various grants and loan to help decrease the project debt service costs.

## **VII. CONCLUSIONS AND RECOMMENDATIONS**

The Town of Bergen facilities at Robins Brook Park and Drew's Nature Center provide a valuable asset to the Town residents.

The existing facilities at Robins Brook Park are well maintained and heavily used during portions of the year for sporting activities. Parking is at a premium during evening sporting events and could use some improvements.

Other than evening youth sporting events, the park is rarely used. Some passive improvements could be made to increase the use of the park including construction of a park pavilion(s), improved parking and road circulation, and construction of a perimeter hiking trail with fitness stations and park benches.

Consideration should be given to relocating the Refuge Transfer Station either offsite to another location in the Town or moving it onsite to the east of the current location. The current location takes away from the usefulness of the northern portion of the park and is unsightly and uninviting as a Town park.

Construction of a park pavilion(s) would provide a location for family picnics and a place for the spectators and sporting participants to seek refuge from the weather during events.

The existing facilities at Drew's Nature Center provide passive enjoyment of nature, however some improvements are warranted.

Parking improvements should be considered at the trail head off West Sweden Road. Those improvements would provide more structure to the parking and allow for more vehicles to use the parking lot. Construction of the proposed informational kiosk should be considered directly off the parking lot at the beginning of the trail.

The parking lot improvements need to be completed in compliance with the Americans with Disabilities Act (ADA). The access from the parking lot to the abandoned railroad bed trail should be ADA compliant which will allow easy access along the trail. The placement of the proposed gazebo should be located towards the beginning of the trail system around the ponds and swamp to allow for those with physical disabilities to access the gazebo.

The Town should continue to nurture the relationships that have been built with the local youth sporting groups that use the Robins Brook Park and also the Bergen Swamp Preservation Society who have a vested interest in the improvements to Drew's Nature Center. In addition, the Town should seek the input and suggestions from the residents.



The Town of Bergen should seek additional State and Federal Government grants for the proposed park improvements at each facility. Once the grant funds are obtained a schedule for completion can be developed.

**Report prepared for the  
Town of Bergen by,**

Chatfield Engineers, P.C.  
2800 Dewey Avenue  
Rochester, NY 14616  
Telephone: 585-227-6040  
[paulchatfield@chatfieldengineers.com](mailto:paulchatfield@chatfieldengineers.com)

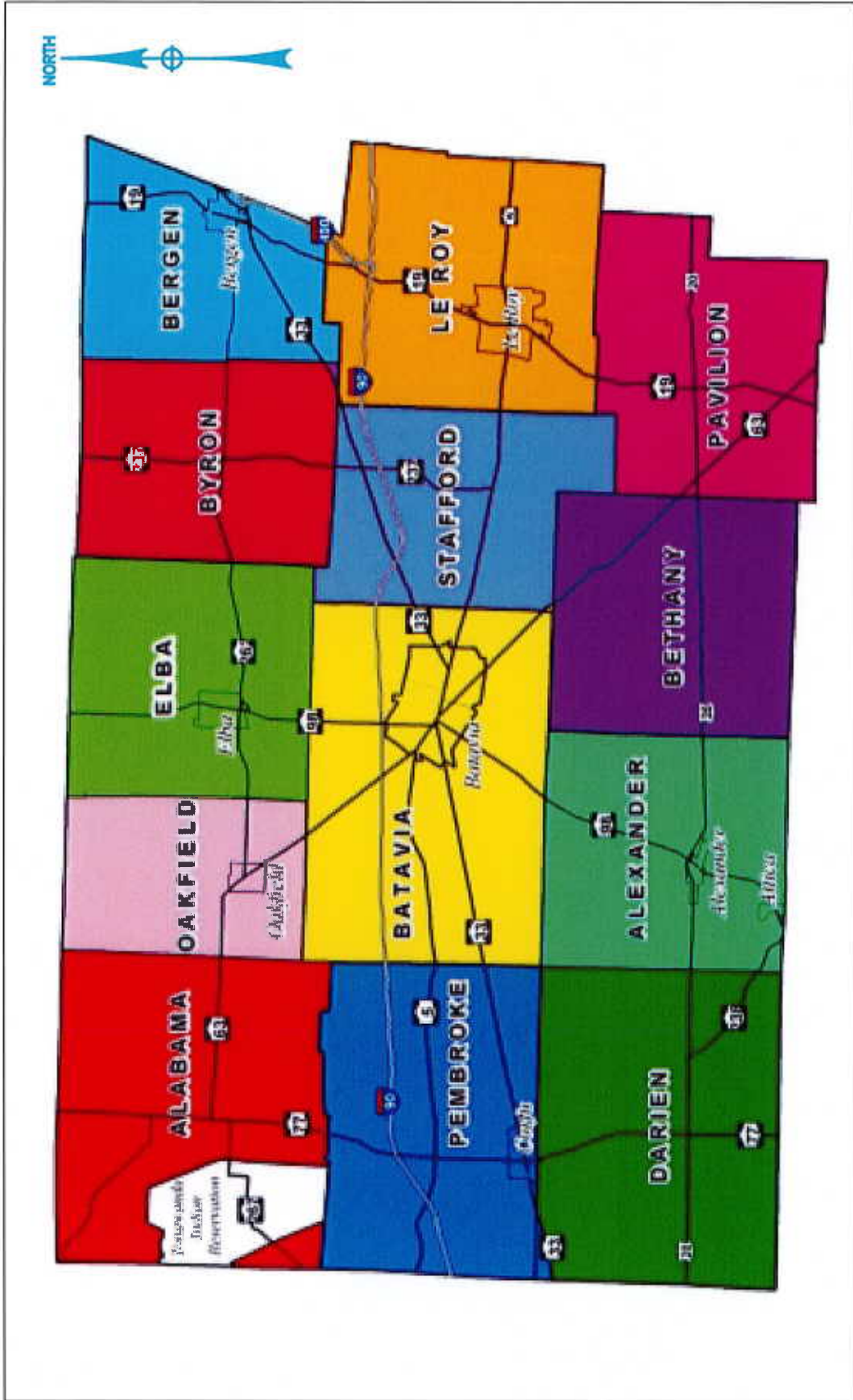

**FIGURE 1**

---

**GENERAL LOCATION MAP**





SCALE: N.T.S.

DATE: 12-08-17

DRAFTED BY: JBL

PROJ. NO.: 17-1222

CHECKED BY: PRC

PROJECT:

TOWN OF BERGEN  
ROBINS BROOK PARK  
PARK IMPROVEMENTS

TITLE:

FIGURE 1  
GENERAL LOCATION MAP

**CHATFIELD ENGINEERS, P.C.**  
2800 Dewey Avenue  
Rochester, New York 14618  
(585) 227-6040 • Fax 227-4233



**FIGURE 2**

---

**PROJECT LOCATION MAP**





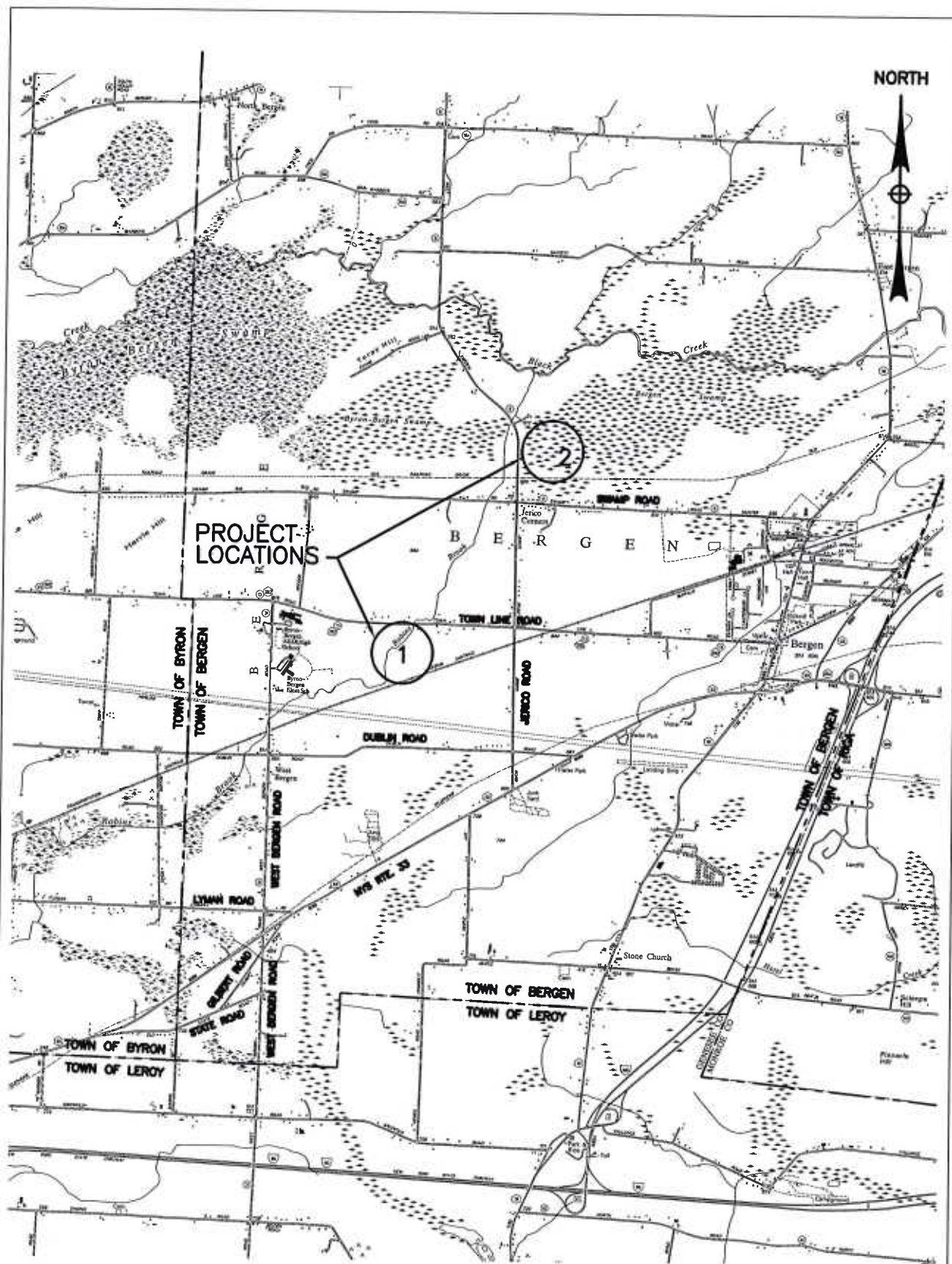

filename: J:\Active\T\Bergen\17-1222 Robbins Brook Park Master Plan\CAD\LocMap.dwg

SCALE:  
1"=3000'  
DRAFTED BY:  
JBL  
CHECKED BY:  
PRC  
DATE:  
12/8/17  
PROJECT NO.:  
17-1222



**CHATFIELD ENGINEERS**  
2800 Dewey Avenue  
Rochester, New York 14616  
(585) 227-6040 • Fax 227-4233

PROJECT:  
TOWN OF BERGEN  
1. ROBINS BROOK PARK  
2. DREW'S NATURE CENTER

TITLE:  
**FIGURE 2  
PROJECT LOCATION MAP**

**FIGURE 3**  
**ROBINS BROOK PARK CONCEPT PLAN**





[illegible]

PROJECT: <b>TOWN OF BERGEN          ROBINS BROOK          PARK IMPROVEMENTS</b>			PROJECT ENGINEER: PRC		NO.	REVISIONS	BY DATE
TITLE: <b>PROPOSED IMPROVEMENTS</b>			DRAFTED BY: JBL				
			CHECKED BY: PRC				
			SCALE: 1" = 60'				
			DATE: DECEMBER 2017				
			FIRM PRINCIPAL		PROJECT MANAGER		

**FIGURE 4**  
**DREW'S NATURE CENTER CONCEPT PLAN**



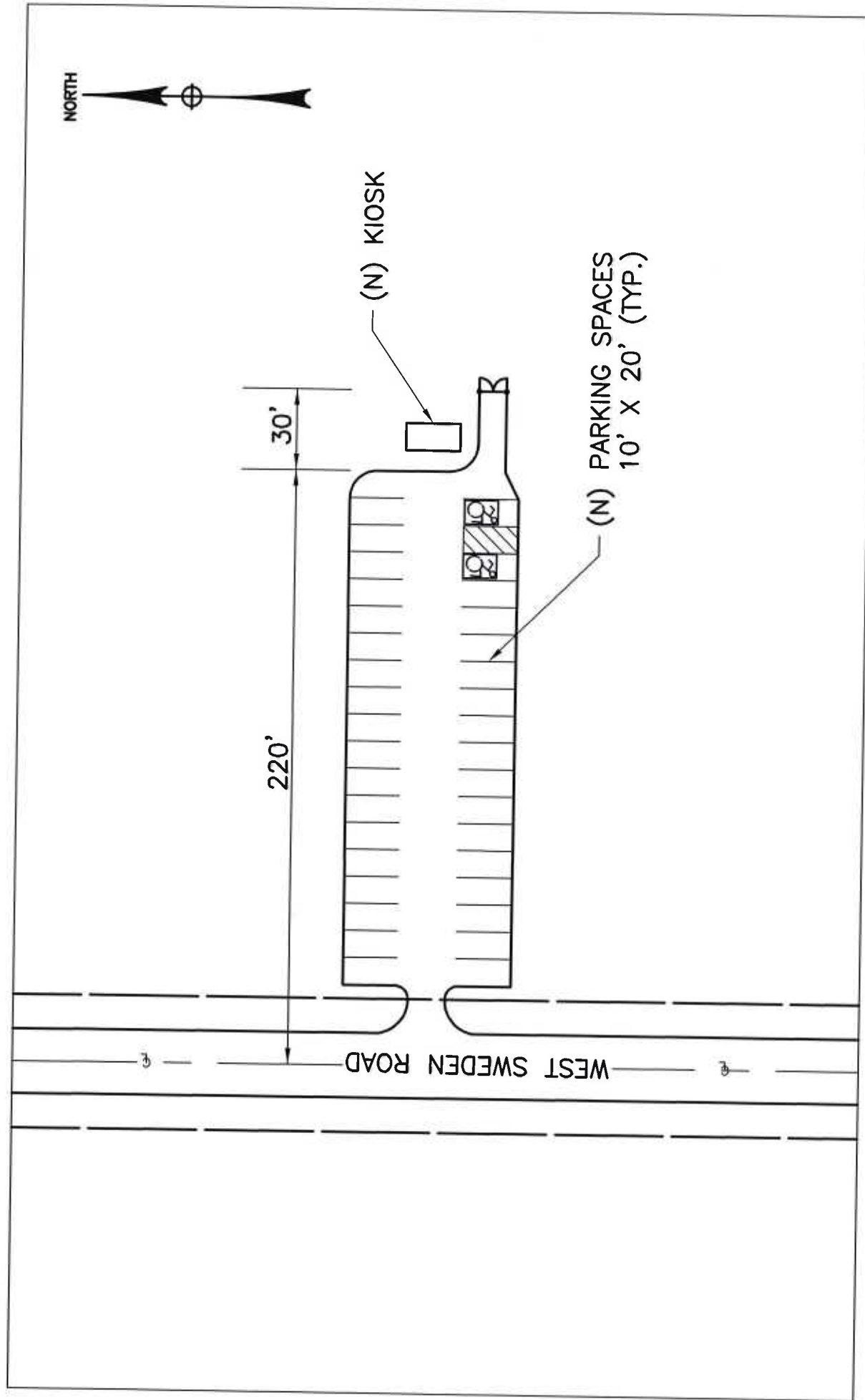

SCALE:	N.T.S.	DATE:	12-08-17
DRAFTED BY:	JBL	PROJ. NO.:	17-1222
CHECKED BY:	PRC		



**CHATFIELD ENGINEERS, P.C.**  
 2800 Dewey Avenue  
 Rochester, New York 14618  
 (585) 227-6040 • Fax 227-4233

PROJECT:  
 TOWN OF BERGEN  
 DREW'S NATURE CENTER

TITLE:  
 FIGURE 4  
 PROPOSED PARKING LOT IMPROVEMENTS



[illegible]

PROJECT No.	17-1222	PROJECT	TOWN OF BERGEN DREW'S NATURE CENTER PARK IMPROVEMENTS	TITLE	PROPOSED IMPROVEMENTS	 <p>CHATFIELD ENGINEERS, P.C. 9000 Engle Road Roseland, New York 14688 US60 227-8040 • Fax 227-4225</p>	PROJECT CHAIRMAN:	DATE	DECEMBER 2017	FIRM PRINCIPAL	PROJECT MANAGER	NO.	REVISIONS	BY	DATE	<p>NO ALTERATION PERMITTED HEREON EXCEPT AS PROVIDED UNDER SECTION 7209 SUBDIVISION 2 OF THE NEW YORK STATE EDUCATION LAW.</p>
							PRC ADAPTED BY JBL CHECKED BY PRC SCALE 1" = 100' DATE									

FIGURE 4

**TABLE 1**  
**PRELIMINARY COST ESTIMATE**



**Table 1**  
**Town of Bergen Park Master Plan**  
**Preliminary Cost Estimate**  
**December 20, 2017**

**DRAFT COPY**

<b>Item No.</b>	<b>Description</b>	<b>Qty</b>	<b>Unit</b>	<b>Unit Price</b>	<b>Estimated Amount</b>
1	Robbins Brook Park Pavilion	2	LS	\$40,000	\$80,000
2	Robbins Brook Park Parking lot Improvements	1	LS	\$55,000	\$55,000
3	Robbins Brook Park Hiking Trail and Signs	1	LS	\$15,000	\$15,000
4	Robbins Brook Park Hiking Trail Fitness Stations and Signs	1	LS	\$13,000	\$13,000
5	Park Benches	12	EA	\$800	\$9,600
6	Park Tables	8	EA	\$400	\$3,200
7	Park Signs	2	EA	\$2,000	\$4,000
8	Kiosks	1	EA	\$5,000	\$5,000
9	Cooking Grills	4	EA	\$750	\$3,000
10	Trash Receptacles	4	EA	\$150	\$600
11	Bike Racks	1	EA	\$500	\$500
12	Fencing Improvements	1	EA	\$10,000	\$10,000
13	Trees and Landscape	1	LS	\$12,000	\$12,000
14	Kiddie Playground	2	EA	\$15,000	\$30,000
15	Soccer Goal Posts	2	EA	\$2,000	\$4,000
16	Kiddie Playground	2	EA	\$12,000	\$24,000
17	Restroom Facilities	1	LS	\$75,000	\$75,000
18	Water Service	1,700	LF	\$28	\$47,600
19	Sanitary Sewer Forcemain	1,700	LF	\$35	\$59,500
20	Sanitary Sewer Grinder Lift Station	1	LS	\$6,000	\$6,000
21	Drew's Nature Center Parking Improvements	1	LS	\$35,000	\$35,000
22	Drew's Nature Center Viewing Platform	2	EA	\$10,000	\$20,000
23	Drew's Nature Center Gazebo	1	LS	\$20,000	\$20,000
24	Drew's Nature Center Hiking Trail and Signs	1	LS	\$30,000	\$30,000
<b>Sub-Total Construction Cost =</b>					<b>\$562,000</b>
Plus Contingencies =					\$56,200
Plus Engineering Services =					\$67,440
Plus Park Master Plan =					\$7,500
Plus Legal and Administration =					\$32,860
<b>Total Estimated Capital Cost =</b>					<b>\$726,000</b>
Less SAM Grant =					(\$125,000)
<b>Net Local Share Amount =</b>					<b>\$601,000</b>
Annual Debt Service Amount (5% for 20 Years) = \$48,225.79					
Total Taxable Assessed Valuation (TAV) = \$159,276,030					
Estimated Tax Rate/\$1,000 AV = \$0.3028					
Estimated "Typical" Single Family Home = \$100,000					
<b>Estimated Annual Cost to the "Typical" Single Family Home =</b>					<b>\$30.28</b>

**APPENDIX A**  
**SELECT PHOTOGRAPHS**





**Town of Bergen**  
**Robins Brook Park and Drew's Nature Center**  
**Appendix A: Selected Photos**



**Robins Brook Park**

Deteriorated fencing along Route 262.  
Consideration should be given to relocating the existing  
Refuge Transfer Station either offsite or to the east.







The Robins Brook Park existing fields are well maintained by the  
Town of Bergen Highway Department



Parking at Robins Brook Park is at a premium.  
Consideration should be given to increasing parking.





Potential location for an open air pavilion off the east end of the existing parking lot (top left).

Elimination of the existing driveway north of Robins Brook (top right).



Potential location of an open air pavilion north of Robins Brook (bottom left).

Proposed parking perpendicular to the roadway south of Robins Brook (bottom right).







Informational Kiosk could be located near the entrance to the trail.



Abandoned railroad bed now serves as trail access to Drew's Nature Center. Closed gate keeps vehicles out of trail.

Consider constructing a gazebo with internal seating at the head of the trail (to allow those with physical disabilities to enjoy).







### **Drew's Nature Center**

Trail improvements are necessary.

Consider constructing a platform with seating around the  
Bergen Swamp



Parking improvements are necessary to accommodate parking for the  
Drew's Nature Center. Better defined parking will allow for more  
vehicles without increasing the existing parking lot footprint.





### **Robins Brook Park**

Open air pavilion possibilities.





**APPENDIX B**  
**MANUFACTURERS CUT SHEETS**

---



# The Raleigh & The Raleigh II



**T**he Raleigh and Raleigh II shelters are distinguished by their appealing laminated wood curved beams and interior tongue and groove wood decking. The Raleigh has laminated wood columns spaced 8' on center, while the Raleigh II has laminated columns spaced 10' on center. The Raleigh II utilizes EnWood Structures' MultiSpan Deck System to increase spacing of structural laminated members. Both shelters combine versatility with economy.

## The Raleigh Sizes Available

12' x 12'	16' x 16'	20' x 20'	24' x 20'
12' x 16'	16' x 20'	20' x 28'	24' x 28'
12' x 20'	16' x 28'	20' x 36'	24' x 36'
12' x 28'	16' x 36'	20' x 44'	24' x 44'
12' x 36'	16' x 44'	20' x 52'	24' x 52'
12' x 44'	16' x 52'	20' x 60'	24' x 60'
30' x 36'	40' x 44'	50' x 52'	60' x 60'
30' x 44'	40' x 52'	50' x 60'	60' x 68'
30' x 52'	40' x 60'	50' x 68'	60' x 76'
30' x 60'	40' x 68'	50' x 76'	60' x 84'
30' x 68'	40' x 76'	50' x 84'	60' x 92'
30' x 76'	40' x 84'	50' x 92'	60' x 100'
30' x 84'	40' x 92'	50' x 100'	60' x 108'
30' x 92'	40' x 100'	50' x 108'	60' x 116'
30' x 100'	40' x 108'	50' x 116'	60' x 124'

Custom Sizes Available

## The Raleigh II Sizes Available

16' x 24'	20' x 24'	30' x 35'	40' x 45'	50' x 55'
16' x 35'	20' x 35'	30' x 45'	40' x 55'	50' x 65'
16' x 45'	20' x 45'	30' x 55'	40' x 65'	50' x 75'
16' x 55'	20' x 55'	30' x 65'	40' x 75'	50' x 85'
16' x 65'	20' x 65'	30' x 75'	40' x 85'	50' x 95'
			40' x 95'	50' x 105'
			40' x 105'	50' x 115'

Custom Sizes Available

\* Requires 3" T & G Decking

## The Raleigh

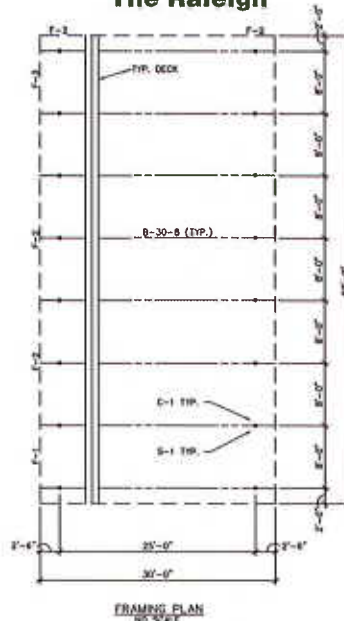

## The Raleigh II

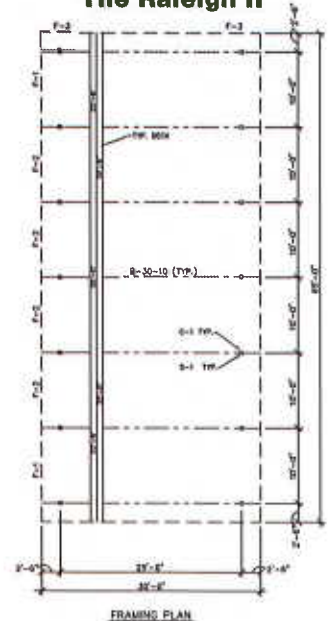



# *Modified Raleigh and Raleigh II shelters*



This Raleigh II shelter measures 50'x95'. Customer selected the optional 5:12 roof pitch and added the EZ-Loc Standing Seam metal roof for color impact.



Custom sized at 26'x100', this Raleigh utilizes side header beams to accommodate additional spacing between the steel tube columns. Installation contractor added the decorative stone features for both visual and practical applications.



Both the Raleigh and Raleigh II shelters, whether large or small are easily adaptable to facilitate enclosures for restrooms, concession space, storage, and administrative offices. Enclosure materials are furnished by your contractor.



Hickory, North Carolina is home to this 50'x105' Raleigh II structure. Their insight for visual impact combined with functional enclosed space in their soccer park area is highly complemented by all who frequent this park.



The visual impact of this Raleigh shelter is characterized by its dramatic 6:12 roof pitch. Normal roof pitch for the Raleigh and Raleigh II is 3:12, however EnWood offers the customer the optional 4:12, 5:12, or 6:12 roof pitch.



All sizes of the Raleigh and Raleigh II shelters are offered with EnWood's optional Bar-B-Q roof design. This design has been engineered to facilitate updraft for ventilation.



## *The Raleigh Hip*



## *The Springwood*





# *Custom Designs*

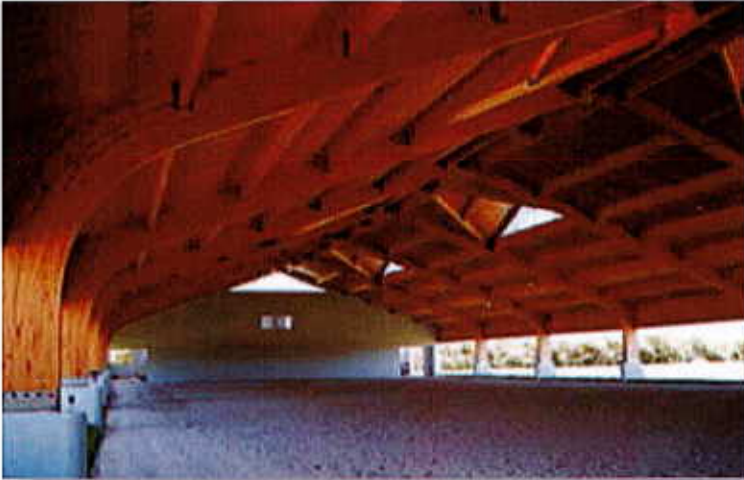



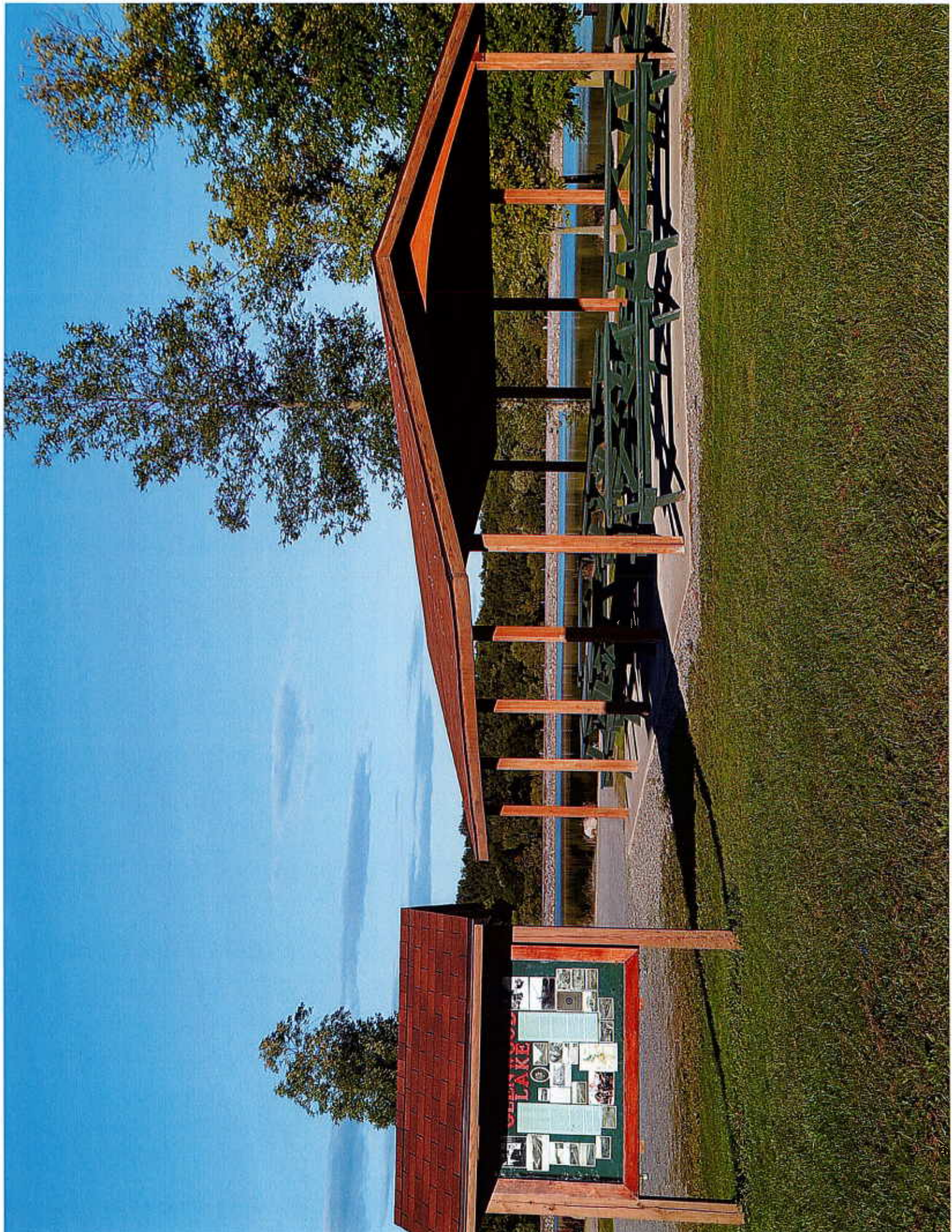



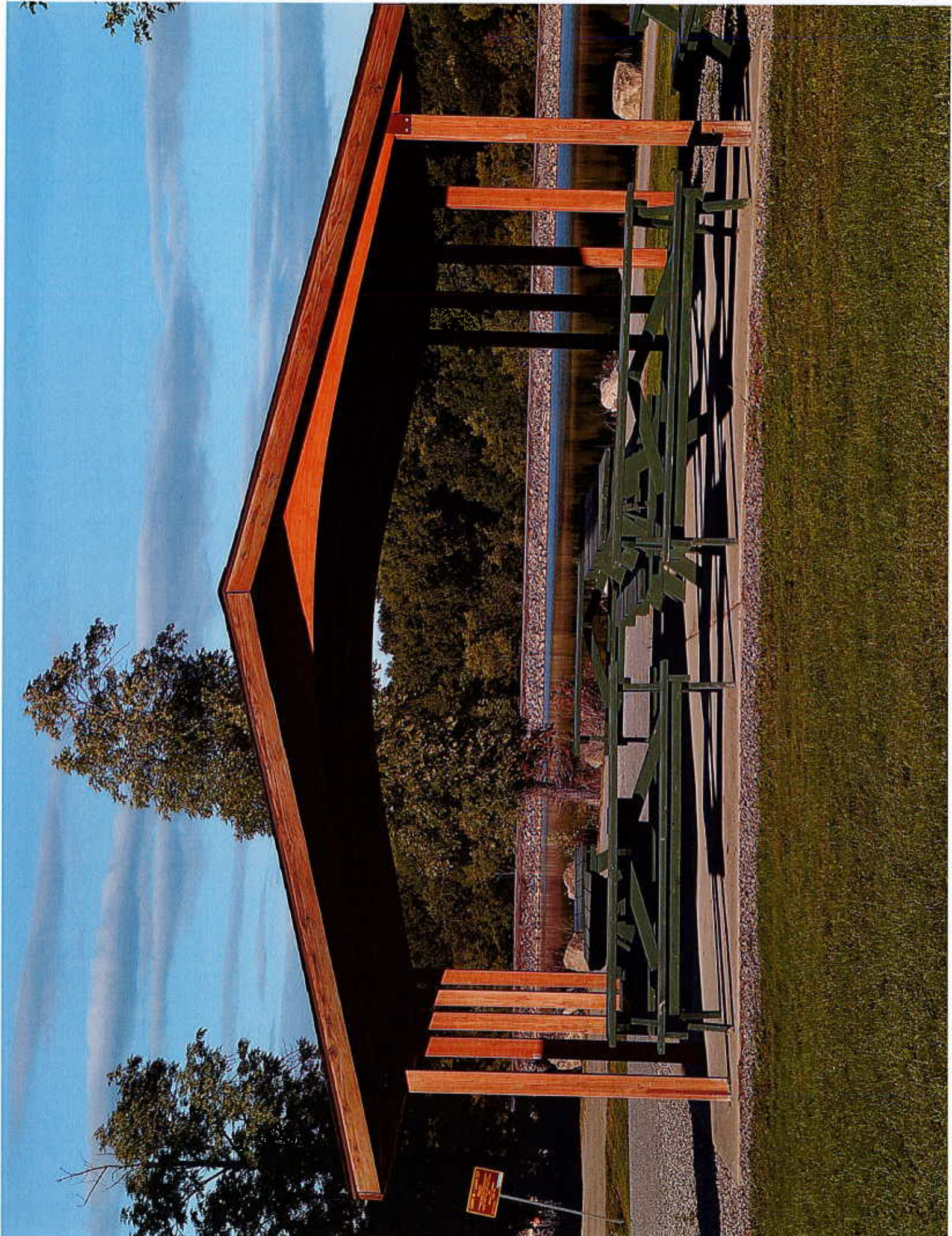



# Gazebos



Let the breezes whisper...

# Welcome!

You are about to experience the beauty and charm of the classic wooden Gazebo. In these pages you will find many styles and features to make

your gazebo special for your landscape.

The floor plans of our gazebos

can be built to your custom

dimensions. The colors,

trimmings, and railings

are your choices, also.

Go ahead relax,

imagine and enjoy!

Read all about it...



## Octagon

Gazebos

### No.1 Octagon Standard



Octagon Floor Plan

Shown with: Cupola, Cedar Shingles, Standard Braces, 1" Railing Spindles, Available in custom dimensions, and painted



Shown with: Cupola, Cedar Shingles, Pagoda Roofline, Standard Braces, 1" Railing Spindles, Available in custom dimensions, and painted





### *No. 2 Octagon Classic*

*Shown with:* Cupola, Cedar Shingles, Standard Braces, 1 x 3 Railing Spindles, 7/12 Roof Pitch, Available in custom dimensions, and painted finish.



*Octagon Floor Plan*

### *No. 2 Octagon Classic*

*Shown with:* Cupola, Cedar Shingles, Colonial Braces, 2 x 2 Railing Spindles, 7/12 Roof Pitch, Aluminum Framed Screens, Available in custom dimensions, and painted finish.



### *No. 5 Octagon Victorian*

*Shown with:* Cupola, Cedar Shingles, Standard Braces, 1 x 3 Railing Spindles, 7/12 Roof Pitch, Available in custom dimensions, and painted finish.

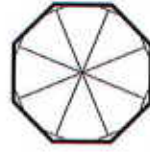

*Octagon Floor Plan*

### *No. 17 Octagon Heritage*

*Shown with:* Cupola, Cedar Shingles, Heritage Braces, 2 x 2 Railing Spindles, Available in custom dimensions, and painted finish.



### *No. 6 Octagon Elegant*

*Shown with:* Cupola, Cedar Shingles, Standard Braces, 1 x 3 Railing Spindles, Available in custom dimensions, and painted finish.



### *No. 4 Octagon Deluxe*

*Shown with:* Cupola, Cedar Shingles, Deluxe Braces, 1 x 3 Railing Spindles, Available in custom dimensions, and painted finish.



## Compare value...

When you purchase a Classic Wooden Gazebo consider these value benefits. Ask the question, "Is it handcrafted?" Handcrafted gazebos are built with attention to fit and

finish. Also ask what type of wood is being used to construct the gazebo. C.A Natural

Select (Arsenic-Free) pressure treated wood has been kiln dried and is ready for paint or clear wood finish -just as you like it.



Share in friendship...



Octagon  
Gazebos



No. 3 Octagon Superior



Octagon Floor Plan

Shown with: Cedar Shingles, Superior Braces, Concave Rafters, 1 x 3 Railing Spindles, Available in custom dimensions, and painted finish.



No. 11 Superior Pagoda

Shown with: Cedar Shingles, Superior Braces, Pagoda Roofline, Concave Rafters, 1 x 3 Railing Spindles, Available in custom dimensions, and painted finish.

# Look at the details

As you consider the size and shape of the gazebo to fit your landscape remember to look at the details of style and construction. Ask, "What kind of screws hold the structure together?" These gazebos are built with

stainless steel screws for maximum durability. You will also like the

Parquet-type floor available on every octagon or oval gazebo. Each board is planed and shaped for smooth finished edges.



Take time to notice the small details

## Oval Gazebos



No. 8 Standard Oval

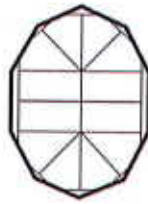

10 Sided Oval Floor Plan

Shown with: Cupola, Cedar Shingles, Standard Braces, 1 x 3 Railing Spindles, Available in custom dimensions, and painted finish.



No. 15 Standard Oval Pagoda

Shown with: Cupola, Cedar Shingles, Standard Braces, Pagoda Roofline, 1 x 3 Railing Spindles, Available in custom dimensions, and painted finish.



# — Enjoy the outdoors —

When you have been in the sun all afternoon, you will be glad for the shaded setting a gazebo offers. The roof over your head is shingled with #1 24" cedar shakes. Should

you desire asphalt shingles, we also offer a variety of colors and styles for you to choose. A

cedar shingled cupola is included as shown in the photos of this brochure. The pitch of the roof can be designed on a custom angle or curve to match your style.



Get ready to make memories.

## Oval

Gazebos



No. 16 Oval

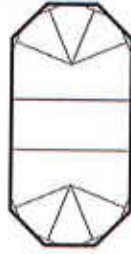

Eight-sided Oval Floor Plan

Shown with: Cupola, Cedar Shingles, Standard Braces, 1 x 3 Railing Spindles, Available in custom dimensions, and painted finish.



No. 14 Oval Pagoda

Shown with: Cedar Shingles, Standard Braces, Pagoda Roofline, 1 x 3 Railing Spindles, Available in custom dimensions, and painted finish.



# Define the Shape

You will shape a smile when we build your gazebo to fit your landscape. The Rectangle's four simple sides bring a formal symmetry to the design. The oval Gazebo can be built on two floor plans. The one floor plan is eight-sided, the other features ten sides.

The equal-sided octagon gazebo can be built to dimensions as low as 8 ft. in diameter.

With all these floor plan options, your gazebo will fit your landscape plan.



Special sizes for everyone...

## Rectangle

Cedarbox



No. 9 Rectangle



Rectangle Floor Plan

Shown with: Cedar Shingles, Standard Braces, 1 x 3 Railing Spindles, Available in custom dimensions, and painted finish.



No. 12 Rectangle Pagoda

Shown with: Cedar Shingles, Standard Braces, Pagoda Roofline, 1 x 3 Railing Spindles, Available in custom dimensions, and painted finish.

# Custom Gazebo Options

Choose a Corner Brace Style



Standard

Colonial

Deluxe

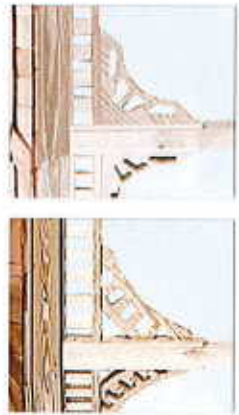

Heritage

Superior

Choose a Floor Plan

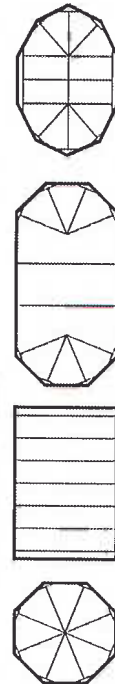

Octagon

Rectangle

Eight-sided Oval

Ten-sided Oval

Choose a Railing Style



2 x 2 Spindle

Counterset Spindles

Turned Spindles

Choose a Roof Color and Type



Cedar Shake Shingles



Architectural Asphalt Shingles



Black

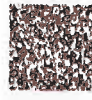

Earth Tone Cedar



Forest Green

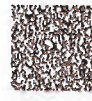

Driftwood



Weathered Wood

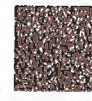

Dual Brown



Dual Gray

Choose a Peakline



Pagoda



7/12 Pitch



Standard



Concave Rafter



Concave Rafter Pagoda

## Options for all Gazebos

- Custom Screens
- White or Brown Aluminum Screen Frames
- Scalloped edge cornices
- Lathe-turned posts and spindles
- Custom Brackets
- White Painted, Clear Wood Finish
- Standard, Deluxe, Heritage, Colonial, or Superior corner braces
- Cupola
- Four Styles of Railings
- Custom Dimensions



Tight Fitting Screens on sides, top, and bottom, keep your event pest free.



Need more custom features?  
...just ask your dealer.

Custom screens include a quality pressure treated wood screen door.

---

# Gazebos

---

Perfect for outdoor living...



*The possibilities for situating  
your gazebo are endless. Take  
in the view, feel the breeze...*



*Enjoy a Classic Wood Gazebo*



[Home](#) > [Premium Wood Grain Benches](#) > **Champion Bench – Premium Wood Grain**

# Champion Bench – Premium Wood Grain

Parent SKU: TBN-154



Reviews

~~\$1,274.85~~

**Sale Price**  
**\$1,018.85**

See Quantity Pricing  
Below



Buy 6 for \$927.85  
each and **save 9%**



Guaranteed	100%
Against Seller	Recycled
Breakage	Content

Need anything? **Just ask!**

# Victory Bench – Wood Grain Naturals



**NEW!**

☆☆☆☆☆ Write a review

Parent SKU: KBN-152

Price From:

**\$631.85**

Upgrade your grounds with the elegant look of natural wood grain.

- Sleek design in a beautiful finish that mimics real wood
- Premium 100% recycled plastic 2 x 4 slats are maintenance-free and weatherproof - never needs oiling or staining
- Sturdy Black recycled plastic frames

[\[Read More...\]](#)

★ REVIEWS

Wood Grain Bench - Walnut



4' 5' 6' 8'



Usually Ships In 2-3 Weeks

## Description Specifications Product Documentation

- Easy assembly with stainless steel hardware included
- Natural wood tone and texture
- 4 ft., 5 ft., 6 ft. and 8 ft. sizes available
- The Deluxe bench is also available as a backless bench
- Custom engraved bronze plaque available
- Surface mount kit available
- 50 year guarantee against breakage

No rotting, rusting, peeling, cracking or painting

## Related Products



### Surface Mount Kit for Benches - (2) 4.5" brackets and (2) 3" brackets

~~\$50.00~~

Sale Price \$43.85



### Cast Bronze Bench Plaques

~~\$95.00~~

Sale Price \$82.85

Choose an Option... ▼

People Who Purchased This, Also Purchased:

[Home](#) → [8-Ft. Wooden Single Post Park Bench](#)
 [Print](#)

## 8-Ft. Wooden Single Post Park Bench

Item #: 398-1244



### \$528.00 / EA

#### Choose your options:

Plank Option \*

\* Required Fields

Qty 1

Choose an Option...

[Add to Cart](#)

Mounting Option \*

Choose an Option...

[Estimate Freight](#)

Color \*

Choose an Option...

#### Buy More and Save!

Price	Qty
\$528.00 / each	1 - 2
\$517.44 / each	3 - 5
\$506.88 / each	6 - 10
\$496.32 / each	11+

[Click here for Bulk Inquiry](#)
[Description](#)   [Specifications](#)   [Product Reviews](#)   [Architect & Product Resources](#)

#### 8-Ft. Wooden Single Post Park Bench

This 8' contour park bench has 2" x 4" planks with 8 wooden slats. The benches have heavy duty 2-3/8" O. D. pipe all MIG welded framework. The hardware is all zinc plated.

**Powder Coating** is an advanced method of applying a decorative and protective finish to a wide range of materials and products that are utilized by both industry and consumers. The charged powder particles adhere to the electrically grounded surfaces until heated and fused into a smooth coating in a curing oven. The result is a uniform, durable, high-quality, and attractive finish.

For complete color options, please see the attached PDF document.

[Product Warranty \(72.44 KB\)](#)

[Spec Sheet \(152.01 KB\)](#)
[My Account](#)
[Free Catalog](#)
[About Us](#)
[Case Studies](#)
[Contact Us](#)
[The Park Blog](#)
[Product Policies](#)
[Video Library](#)
[Privacy Policy](#)
[Order Tracking](#)

Talk to an expert

1-866-293-8528



[Home](#) → [Everest Series 8-Ft Heavy Duty ADA Picnic Table](#)

[Print](#)

# Everest Series 8-Ft Heavy Duty ADA Picnic Table

Item #: 398-6007



**\$653.00 / EA** ~~\$881.00~~ (Save 26%)

## Choose your options:

Pattern Type \* \* Required Fields

Choose an Option...

Style \*

Choose an Option...

Color \*

Choose an Option...

Qty 1

[Add to Cart](#)



[Estimate Freight](#)

## Buy More and Save!

Price	Qty
\$653.00 / each	1 - 2
\$639.94 / each	3 - 5
\$626.89 / each	6 - 10
\$613.82 / each	11+

[Click here for Bulk Inquiry](#)

[Description](#)   [Specifications](#)   [Product Reviews](#)   [Architect & Product Resources](#)

This Everest Series 8-Ft heavy duty ADA picnic table is as attractive as it is durable. This picnic table features a convenient walk-through design for easy access to seating, and is handicap accessible, making access easy for anyone who wants to enjoy an outdoor meal. This table is thermoplastic coated which helps to add strength to the bench and extends the life of the color.

Thermoplastic coating is a coating process that melts to form a fusion bonded coating, and then cools to produce superior physical properties.

This picnic table can be ordered with either a diamond or a perforated pattern and is available with a single or double sided design. Frame color is black only.

**Item is shown in diamond pattern.**

**Please Note:** This item has pre-drilled holes in the frame that can be used for the Surface option.

[Product Warranty \(72.44 KB\)](#)

[Spec Sheet \(5.56 MB\)](#)

## Recently Viewed Products



[8-Ft. Wooden Single Post Park Bench](#)



[4 Row Aluminum Bleachers - Sideline Series](#)

[Home](#) → 4 Row Aluminum Bleachers - Sideline Series

[Print](#)

# 4 Row Aluminum Bleachers - Sideline Series

Item #: 569-1222



\$847.00 / EA

Choose your options:

Length \*

\* Required Fields

Qty

1

Choose an Option...

Shop Drawings \*

Choose an Option...

Anchoring Option \*

Choose an Option...



Add to Cart



[Estimate Freight](#)

[Click here for Bulk Inquiry](#)

- 2012 IBC Compliant
- Will look new for years with minimum maintenance
- Seats up to 72 people
- Anodized aluminum planks and frames
- Galvanized hardware
- Ships knocked down
- 3 Day ParkExpress
- NOTE: If you add anchors to your order, it will ship out at regular lead time (3-6 weeks)

[Description](#)   [Specifications](#)   [Product Reviews](#)   [Architect & Product Resources](#)

**Product Details:**

This series starts with a high quality anodized aluminum and welded joint structure that's enhanced with swivel casters and special rubber pads to make the 4 Row Aluminum bleacher system portable and sturdy. The pads protect all flooring types from scuffs or dents, so the 4 Row Aluminum bleacher unit is great for indoor or outdoor spaces. Three-rows of seating and foot planks will seat anywhere from 15 to 54 people, depending on the length of the unit. 4 Row Aluminum bleachers are great for flat and hard ground surfaces or on soft, grassy grounds with ground sill stabilizers.

**Not Included:**

- Assembly (All bleachers shipped knocked down.)
- Ground sill stabilizers for uneven or soft ground surfaces
- Shop drawings
- Anchor kit

PLEASE NOTE: These bleachers feature a first row seat height under 12"

Please see the dimension chart below for details about height and the space requirements.

Length	Seating Capacity	Weight
15'L	40	292 LB

[Home](#) → [Galvanized Outdoor Charcoal Grill](#) [Print](#)

## Galvanized Outdoor Charcoal Grill

Item #: 166-1301

**\$255.00 / EA**

Choose your options:

Mount Type \*

\* Required Fields

Qty 1

Choose an Option...

[Add to Cart](#)[Estimate Freight](#)

### Buy More and Save!

Price	Qty
\$255.00 / each	1 - 2
\$249.90 / each	3 - 5
\$244.80 / each	6 - 10
\$239.70 / each	11+

[Click here for Bulk Inquiry](#)[Description](#) [Specifications](#) [Product Reviews](#) [Architect & Product Resources](#)

### Galvanized Outdoor Charcoal Grill

#### This Grill Sizzles!

This new exclusive grill is a welcome addition to our extensive collection of park grills. It's a high-quality park grill with an attractive price. It features an in-ground mounting option, hot dipped galvanized finish, and adjustable grill height.

The rack is made of 1/2" steel rods.  
The pole is 2-3/8" OD Sched. 40 Steel.

- 300 Sq. In. Cooking Area
- Firebox Dimensions: 14"x20½"x10"
- Overall dimensions: 25"Wx50"H (14" goes In-Ground; 36" above ground)
- High Quality!
- Hot Dipped Galvanized
- Adjustable Grill Height
- In-Ground Mount

 [Product Warranty \(143.40 KB\)](#) [Spec Sheet \(299.32 KB\)](#)

### Recently Viewed Products

[8-Ft. Wooden Single Post Park Bench](#)[4 Row Aluminum Bleachers - Sideline Series](#)[Everest Series 8-Ft Heavy Duty ADA Picnic Table](#)



# Standard Pet Waste Bag Dispenser

★★★★★ 1 Review

Parent SKU: KPET-01

Price From:  
**\$238.85**

Includes dual-bag dispenser & 2 free rolls of bags (400).  
Surface mount and inground models come with a post.

- Material: Recycled plastic
- 400-bag capacity (2 rolls)

[Read More...]

Choose an Option...

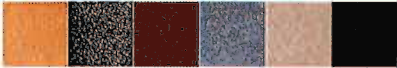

Usually Ships in 3-5 Days

★ REVIEWS



## Description Specifications

- Help pet owners clean up after their pets
- Dual bag dispenser constructed of recycled plastic
- Includes 2 free rolls of dog waste bags (400 bags!)
- Hinged top with magnetic catch
- Stainless steel hasp for padlock (padlock not included)
- Dispenser can be mounted anywhere
- Guaranteed against breakage for 50 years!

## Related Products



### Pet Litter Roll Bags

~~\$118.00~~  
Sale Price \$95.00

People Who Purchased This, Also Purchased:



### Deluxe Pet Waste Bag Dispenser

# Traditional Galvanized PLUS Bike Racks

★★★★★ 1 Review

Parent SKU: KBR-04

Price From:

## \$478.85

Small and large bike capacity options, all protected by a durable coating.

- Material: Heavy-gauge steel
- Finish: Galvanized PLUS
- 1-5/8" OD steel frame
- Tubing for Locking: Galvanized PLUS coated 14-gauge steel crossbars, securely welded on top & bottom
- Holds 5, 9, 10 or 18 bikes, depending upon which bike capacity you choose

[Read More...]

5	9	10	18
---	---	----	----

Usually Ships in 3-5 Days

★ REVIEWS

•bike rack, double-sided, galvanized



## Description Specifications Product Documentation

- Select 5-bike up to 18-bike capacity
- 1-5/8" OD frame with 14-gauge crossbars securely welded at top and bottom
- Galvanized PLUS clear coat finish
- Shipped knocked down, save \$ on shipping
- Simple assembly required

Traditional style complements any setting

## Related Products



Bike Parking Only Sign

\$25.85

Choose an Option... ▼

People Who Purchased This, Also Purchased:





# 2017-18 TRAIL SAMPLE PACKAGE 1

12 UNITS 32 USERS



BIXBY  
PARK  
CITY OF  
LONG BEACH





# 2017-18 TRAIL SAMPLE PACKAGE 1

12 UNITS 32 USERS

## UNITS

<b>Area 1</b> SGR2005-1-48-W SHP2009-5-07 SGR2005-1-105	2-Person Accessible Lat Pull 2-Person Full Bar Exercise Customized Announcement Sign
<b>Area 2</b> SGR2005-1-19 SGR2005-1-48A-W SGR2005-1-105	2-Person Incline Sit-Up Bench 2-Person Accessible Chest Press Customized Announcement Sign
<b>Area 3</b> SGR2005-1-42 SHP2009-5-10 SGR2005-1-105	2-Person Back and Arms Combo 4-Person Combo Bars Customized Announcement Sign
<b>Area 4</b> SGR2005-1-21 SGR2005-1-45 SGR2005-1-105	4-Person Lower Body Combo 2-Level Horizontal Bars Customized Announcement Sign
<b>Area 5</b> SGR2005-1-104N SHP2009-7-24 SGR2005-1-105	4-Person Leg Press Plyometric Steps (Set of 3) Customized Announcement Sign
<b>Area 6</b> SGR2005-1-22 SGR2005-1-43 SGR2005-1-105	4-Person Pendulum, Abs, & Dips Station Parallel Bars Customized Announcement Sign

**Six mini-clusters with activities for entry-level and advanced users at each**

Designed to complement cardio workouts, the 12-unit Trail Sample Package 1 emphasizes upper body and core exercises.

### Available options:

- Announcement sign customization - layout, text and graphics 100% customizable on both sides
- Shade
- Site amenities

PACKAGE SPECS	
Units	12
Users	32
Required Dimensions	varies



# 2017-18 TRAIL SAMPLE PACKAGE 1

Six mini-clusters with activities for entry-level and advanced users at each

12 UNITS 32 USERS





# 2017-18 TRAIL SAMPLE PACKAGE 1

Six mini-clusters with activities for entry-level and advanced users at each

12 UNITS 32 USERS

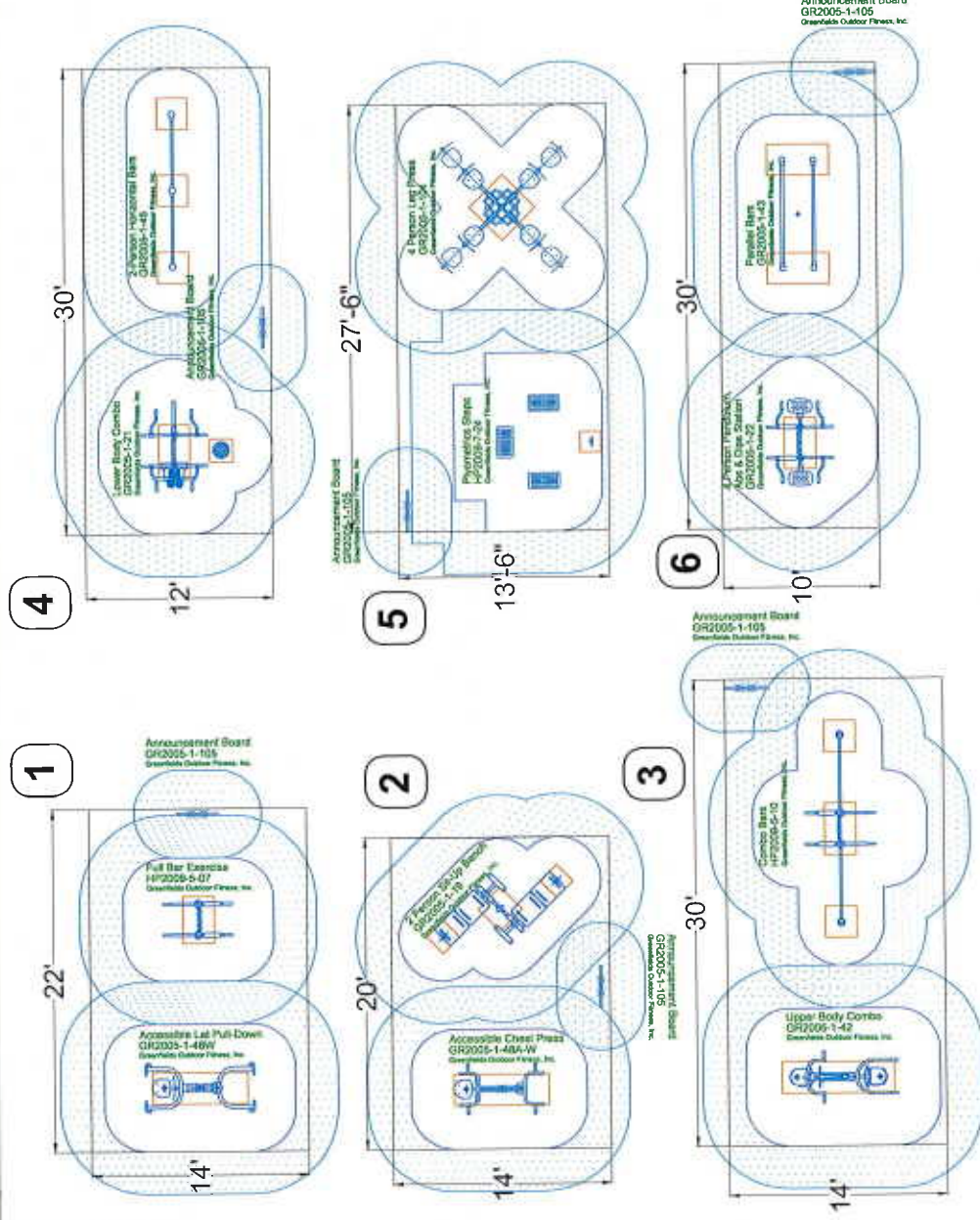
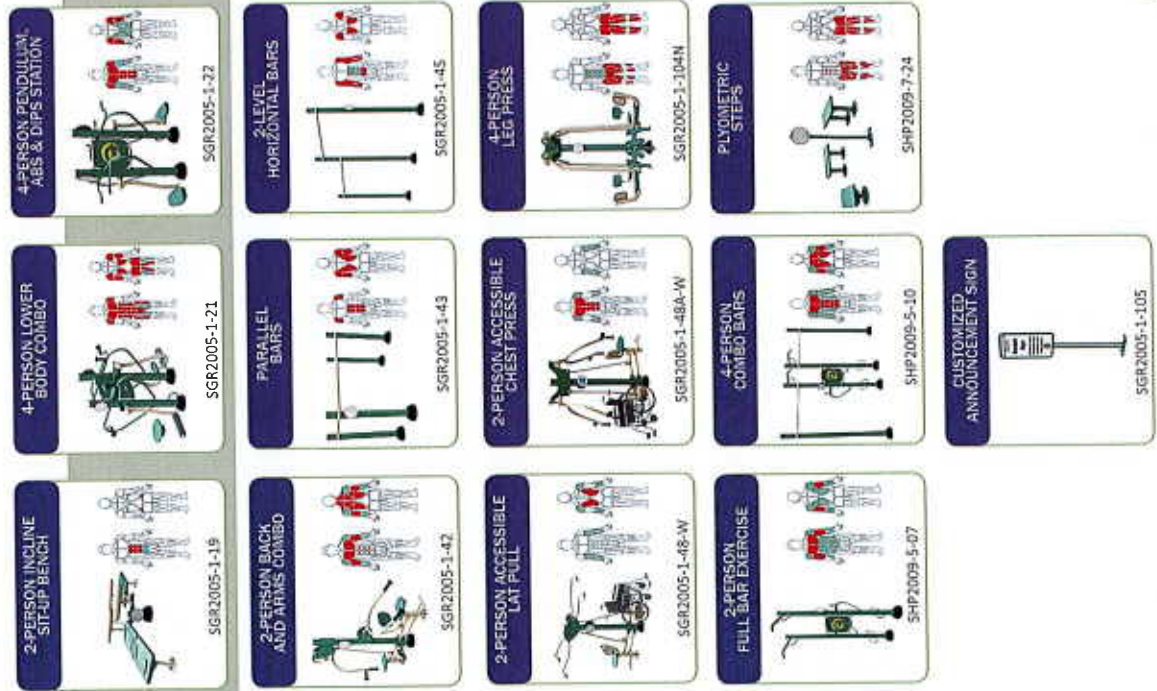



# 2017-18 TRAIL SAMPLE PACKAGE 1

Six mini-clusters with activities for entry-level and advanced users at each

12 UNITS 32 USERS



## UNIT LIST

Area 1  
SGR2005-1-48-W  
SHP2009-5-07  
SGR2005-1-105

2-Person Accessible Lat Pull  
2-Person Full Bar Exercise  
Customized Announcement Sign



Area 2  
SGR2005-1-19  
SGR2005-1-48A-W  
SGR2005-1-105

2-Person Incline Sit-Up Bench  
2-Person Accessible Chest Press  
Customized Announcement Sign

Area 3  
SGR2005-1-42  
SHP2009-5-10  
SGR2005-1-105

2-Person Back and Arms Combo  
2-Person Combo Bars  
Customized Announcement Sign

Area 4  
SGR2005-1-21  
SGR2005-1-45  
SGR2005-1-105

4-Person Lower Body Combo  
2-Level Horizontal Bars  
Customized Announcement Sign

Area 5  
SGR2005-1-104N  
SHP2009-7-24  
SGR2005-1-105

4-Person Leg Press  
Plyometric Steps (Set of 3)  
Customized Announcement Sign

Area 6  
SGR2005-1-22  
SGR2005-1-43  
SGR2005-1-105

4-Person Pendulum, Abs, & Dips Station  
Parallels Bars  
Customized Announcement Sign (see right)

These 12 units may serve up to 32 people at a time.

Please be advised that the use of DG (Decomposed Granite) increases the normal wear & tear of all footrests and other platforms used by the users.



# ENHANCE YOUR PACKAGE!

Greenfields offers these products and more for the best user experience



**Benches**



**Trash receptacles**



**Bike racks**

What's underneath?  
Lighting allows for after-dark  
workouts - perfect for parents  
attending evening games!



## SHADE OPTIONS

Designed to fit your project's  
unique needs



**Shade canopy**



**Shade sails**



**Multi-level shade**



# 2017-18 TRAIL SAMPLE PACKAGE 2

21 UNITS 55 USERS





# 2017-18 TRAIL SAMPLE PACKAGE 2

21 UNITS 55 USERS



## UNITS

Area 1		Area 3	
SGR2005-1-42	2-Person Back and Arms Combo	SGR2004-1-33	Multi-Level Bars
SGR2005-1-47	2-Person Vertical Press	SGR2005-1-14	2-Person Dips Station
SGR2005-1-48	2-Person Lat Pull	SGR2005-1-19	2-Person Incline Sit-Up Bench
SGR2005-1-48A	2-Person Chest Press	SHP2009-5-10	4-Person Combo Bars
SGR2005-1-71	3-Person Static Combo	SHP2009-7-24	Plyometric Steps (Set of 3)
SGR2005-1-105	Customized Announcement Sign	SHP2009-7-25	Back Extension
		SGR2005-1-105	Customized Announcement Sign
Area 2		Area 4	
SGR2005-1-21	4-Person Lower Body Combo	SHP2009-5-09	Horizontal Ladder
SGR2005-1-48E	Combo Butterfly & Reverse Fly	SHP2009-5-12	10-Person Static Combo
SGR2005-1-91	3-Person Static Combo	SHP2009-7-24	Plyometric Steps (Set of 3)
SGR2005-1-98	Rowing Machine	SHP2009-7-25	Back Extension
SGR2005-1-105	Leg Extension	UBX-360	Balancing Plate
	Customized Announcement Sign	SGR2005-1-105	Customized Announcement Sign

## Four clusters with a broad range of strength-building units

Greenfields' 21-unit Trail Sample Package 2 is the premiere trail enhancement fitness package! Incorporating such multi-user elements such as Greenfields' new 10-Person Static Combo and 4-Person Lower Body Combo, this 55-user cluster makes maximum use of space to provide a vast array of fitness apparatuses to trail users.

### Available options:

- Announcement sign customization - layout, text and graphics 100% customizable on both sides
  - Shade
  - Site amenities

PACKAGE SPECS		
Units	21	
Users	55	
Required Dimensions		varies





# 2017-18 TRAIL SAMPLE PACKAGE 2

Four clusters with a broad range of strength-building units

21 UNITS 55 USERS

1

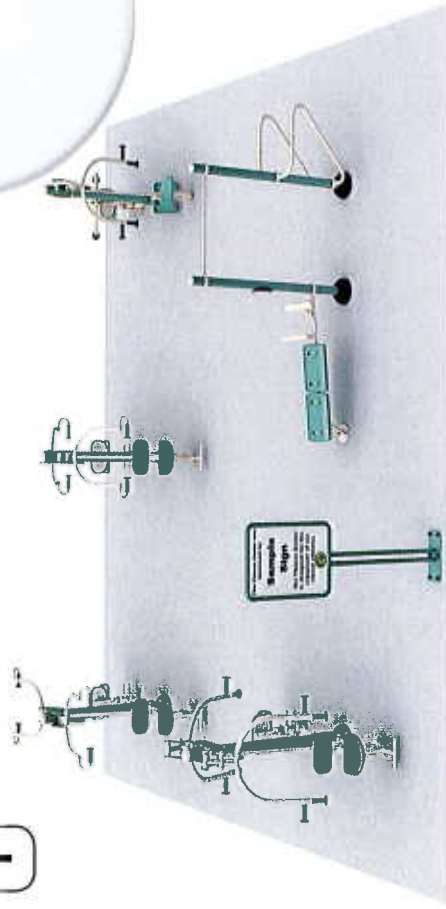

3

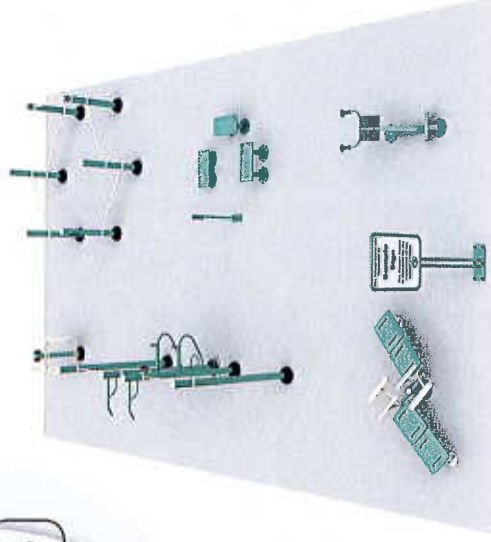

2

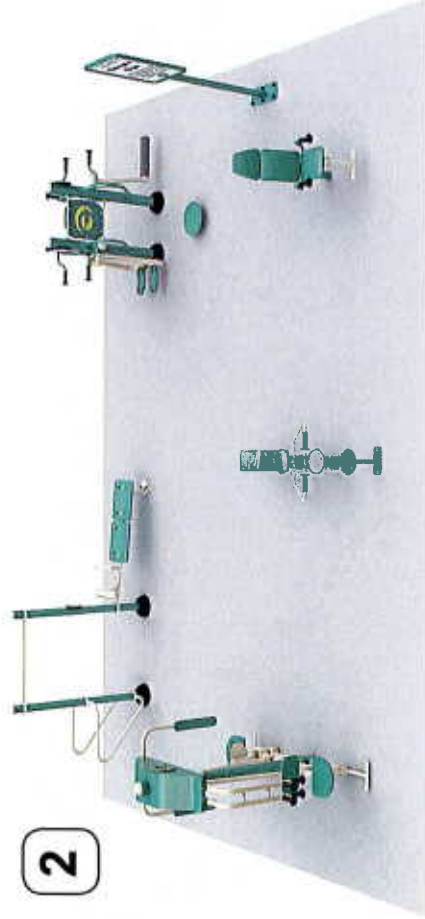

4



# 2017-18 TRAIL SAMPLE PACKAGE 2

Four clusters with a broad range of strength-building units

21 UNITS 55 USERS





# 2017-18 TRAIL SAMPLE PACKAGE 2

Four clusters with a broad range of strength-building units

21 UNITS 55 USERS

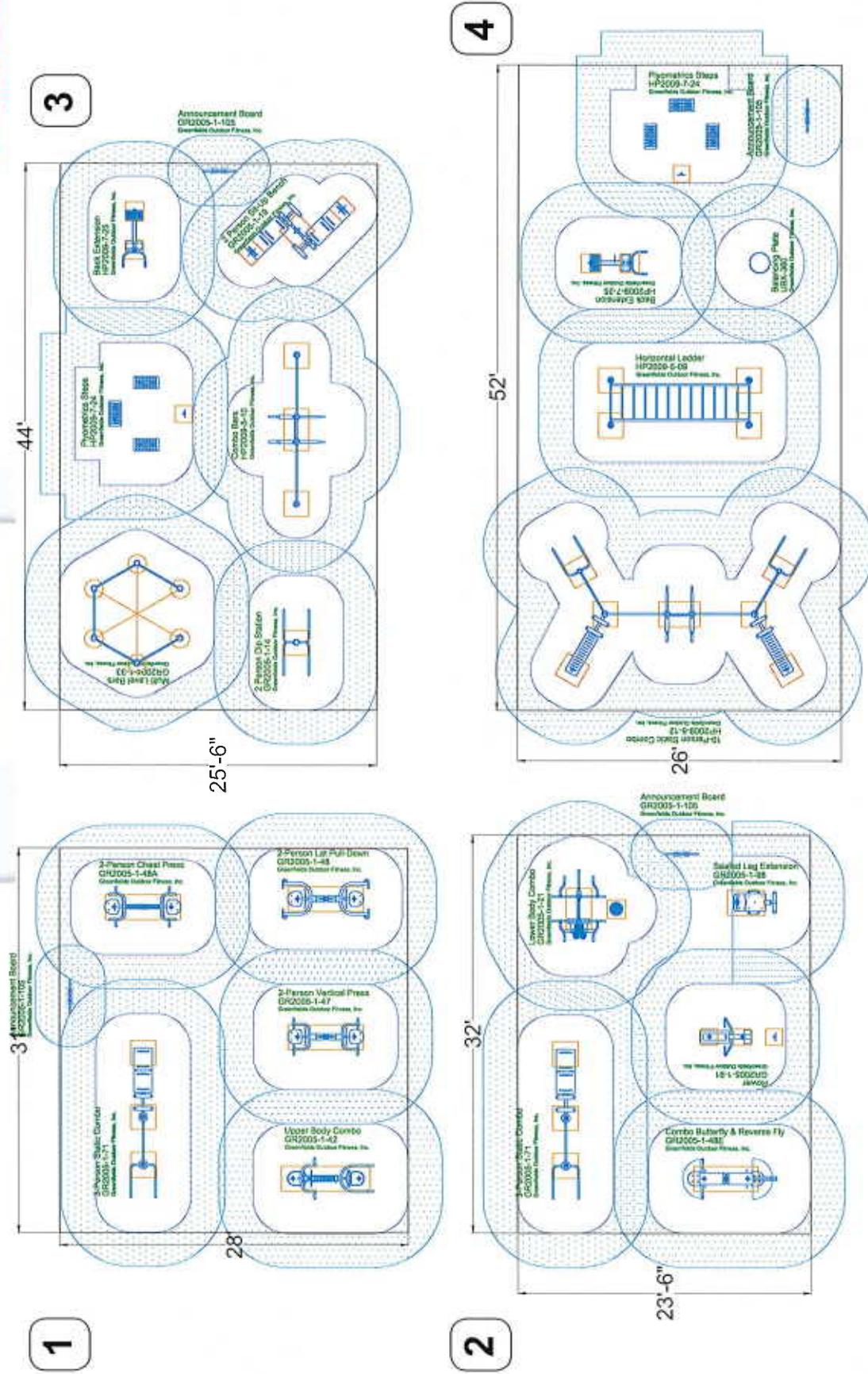



# 2017-18 TRAIL SAMPLE PACKAGE 2

Four clusters with a broad range of strength-building units

21 UNITS 55 USERS



## UNIT LIST

- |               |  |
|---------------|--|
| <b>Area 1</b> | 2-Person Back & Arms Combo             |
| SGR2005-1-42  | 2-Person Vertical Press                |
| SGR2005-1-47  | 2-Person Lat Pull                      |
| SGR2005-1-48  | 2-Person Chest Press                   |
| SGR2005-1-48A | 3-Person Static Combo                  |
| SGR2005-1-71  | Customized Announcement Sign           |
| SGR2005-1-105 |  |
| <b>Area 2</b> | 4-Person Lower Body Combo              |
| SGR2005-1-21  | 2-Person Combo Butterfly & Reverse Fly |
| SGR2005-1-48E | 3-Person Static Combo                  |
| SGR2005-1-71  | Rowing Machine                         |
| SGR2005-1-91  | Leg Extension                          |
| SGR2005-1-98  | Customized Announcement Sign           |
| SGR2005-1-105 |  |
| <b>Area 3</b> | Multi-Level Bars                       |
| SGR2004-1-33  | 2-Person Dips Station                  |
| SGR2005-1-14  | 2-Person Incline Sit-Up Bench          |
| SGR2005-1-19  | 4-Person Combo Bars                    |
| SHP2009-5-10  | Plyometrics Steps (set of 3)           |
| SHP2009-7-24  | Back Extension                         |
| SHP2009-7-25  | Customized Announcement Sign           |
| SGR2005-1-105 |  |
| <b>Area 4</b> | Horizontal Ladder                      |
| SHP2009-5-09  | 10-Person Static Combo                 |
| SHP2009-5-12  | Plyometric Steps (Set of 3)            |
| SHP2009-7-24  | Back Extension                         |
| SHP2009-7-25  | Balancing Plate                        |
| UBX-360       | Customized Announcement Sign           |
| SGR2005-1-105 |  |

These 21 units may serve up to 55 people at a time.

Please be advised that the use of DG (Decomposed Granite) increases the normal wear & tear of all footrests and other platforms used by the users.



# **ENHANCE YOUR PACKAGE!**

Greenfields offers these products and more for the best user experience



**Benches**



**Trash receptacles**



**Bike racks**

**What's underneath?**  
Lighting allows for after-dark workouts - perfect for parents attending evening games!



## **SHADE OPTIONS**

Designed to fit your project's unique needs



**Shade canopy**



**Shade sails**



**Multi-level shade**



# Outdoor Fitness Park Guide from PlayCore

Exercises

• [Fitness Parks](#)

• [Exercises](#)

• [Benefits](#)

• [About](#)

• [Contact](#)

• [All](#)

• [Aerobic](#)

• [Balance](#)

• [Core Health](#)

• [Strength](#)

## START A FITNESS PARK IN YOUR NEIGHBORHOOD

Make physical activity and exercise more available, more accessible, more affordable, and more enjoyable to your community.

Get Started Today!

FITNESS PARK BENEFITS

[Balance Beam](#)



• [Balance Board](#)



• [Balance Plank](#)



• [Bench Dip](#)



[Body Curl Station](#)



• [Captain's Chair](#)



• [Cardio Walker](#)



• [Chest Press](#)



[Chin Up](#)



• [Elliptical](#)



• [Hand Cycle](#)



• [High Jump](#)



[Horizontal Chin-Up](#)

• [Hurdle](#)

• [Joint Use Pull-Up Bar](#)

• [Knee Lift](#)



Lat Pulldown• Leg Press• Log Hop• Parallel Bar StationPlyometric Box• Push Up• Push-Up• Recumbent BikeSit Up & Back Extension• Sit-Up• Step Up Station• T BarUpright Cycle• Vault Bar



FOR TRAILS 1/4-1 MILE

# TYPICAL 10 STATION JOGGING SYSTEM LAYOUT

